

AM Bickford PC-2 Non-rebreathing Systems

The AM BICKFORD PC-2 NON-REBREATHING SYSTEM is for use in administering anesthesia to small animal patients up to approximately 10lb. body weight. It offers the advantages of the side vented breathing bag arrangement, plus the advantage of eliminating the unhealthy and annoying discharge of waste gases into the faces of operating room personnel. The PC-2 valve placed at the bag vent permits one hand resuscitation, controlling the vent by thumb pressure while squeezing the bag for manual inflation of the lungs. Waste gases are conducted away through a discharge tube to floor level, or to other disposal means. The NRB elbow provides for standard mask and endotracheal tube connections. Washed-down volume is maximized by placement of the fresh gas supply tube as close as compatibility with standard connectors permits. Since some parts are not conductive, systems should be considered non-conductive.

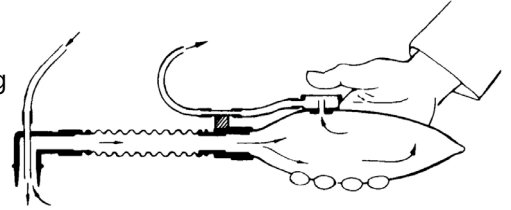

Complete systems



PC-2A
80010

The lightweight plastic Non-Rebreathing mask elbow connects directly to a **1 Liter** 7/8" neck conductive rubber Breathing Bag. PC-2 valve, supply and discharge tubing. The 80010 is assembled and ready for use. Vaporizer connectors included.



PC-2B
80011

The lightweight plastic Non-Rebreathing mask elbow, **1 Liter** 7/8" neck conductive rubber breathing bag with attached discharge tube terminal, PC-2 valve. Also included 6" x 5/8" diameter pediatric extension tube with 22mm male and 15mm female plastic ends. The 80011 is assembled and ready to use. Vaporizer connectors included.



PC-2C
80012

The lightweight plastic Non-Rebreathing mask elbow, **1/2 Liter** 7/8" neck conductive rubber breathing bag with attached discharge tube terminal, PC-2 valve. Also included 6" x 5/8" diameter pediatric extension tube with 22mm male and 15mm female plastic ends. The 80012 is assembled and ready to use. Vaporizer connectors included.

PC-2 Parts & Component Assemblies



80110 1 Liter Breathing Bag with PC-2 valve and tube terminal.

80111 1/2 Liter Breathing Bag, with PC-2 valve, and tube terminal.

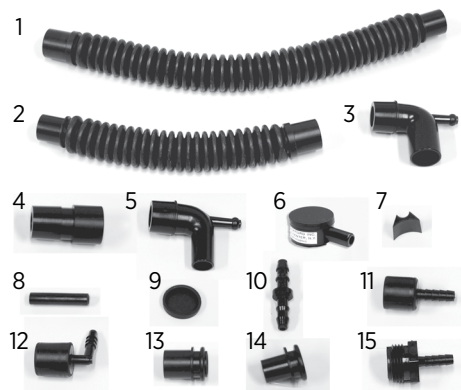

1. **80101** 10" x 5/8" Pediatric Extension Tube, with 15mm female end and 22mm male ends.
2. **80102** 6" x 5/8" Pediatric Extension Tube, with 15mm female end and 22mm male ends.
3. **80103** Mask Elbow with gas inlet tube for 3/16" or 1/4" tubing and 7/8" distal end.
4. **80104** Bag Adapter, 22mm or 7/8" bag neck to 15mm female.
5. **06114** Mask Elbow with gas inlet tube, connects to 3/16" I.D. tubing.
6. **80106** PC-2 Valve Complete. Installs in 3/16" breathing bag hole.
7. **80107** Mounting Block, supports tube (8) on bag adapter, forming tube terminal.
8. **80108** 13/4" x 5/16" Tube, mounts on (7) forming tube terminal for 1/4" I.D. tubing.
9. **80109** Diaphragm-PC-2 Valve, molded neoprene, for replacement.
10. **80700** Tubing Splicer, 1/4" or 3/16" I.D. tubing to vaporizer outlet (N.A.D. Vapor).
11. **05503** Connector, 1/4" I.D. tubing to 7/8" diameter breathing tube.
12. **05504** Connector, 1/4" tube x 23mm male. Connect 1/4" or 3/16" tubing to vaporizer outlet.
13. **80113** Adapter, 15mm female to 5/8" pediatric tube, or rolled neck bag.
14. **80114** Adapter, 15mm male to 5/8" pediatric breathing tube.
15. **05505** Connector, 1/4" tubing x G.H.T. connects 1/4" tubing to standard garden hose.



18552 Connecting Tubing 3/16" I.D. x 5" for fresh gas supply.

18453 Connecting Tube 1/4" I.D. x 4" for waste gas discharge.

18711 Replacement Bag, 1 Liter with punched hole.

18910 Replacement Bag, 1/2 Liter with punched hole.

80115 Adapter, 22mm male to pediatric breathing tube.

80116 Adapter, 22mm female to pediatric breathing tube.

Distributed for Veterinary use by:



12318 Big Tree Road
Wales Center, New York 14169

Phone: 716-652-1590
Fax: 716-652-2046

Toll free: 1-800-795-3062
Web: ambickford.com
Email: sales@ambickford.com